

PHASE I-2010
 Fully Renovated Tennis Courts
 New JV Baseball Field
 New V Softball Field
 New JV Softball Field
 New Batting Cages
 New Storage and Concession Building
 New JV/Practice Soccer Field
 New Automated Irrigation System

PHASE II-2011
 New 400 meter Track and Field Facility
 New Football Field/Soccer Field
 New Batting Cages
 New Storage Building
 New Entry Gateway/Ticket Booth
 and Concessions Bldg
 New 1,256 Seat Stadium Bleachers
 New Automated Irrigation System



ACRE SCALE

B W A BERNARDO WILLS
 ARCHITECTS PC

153 SOUTH JEFFERSON SPOKANE WASHINGTON 99201
 509.838.4511 FAX 509.838.4605 WWW.BERNARDOWILLS.COM

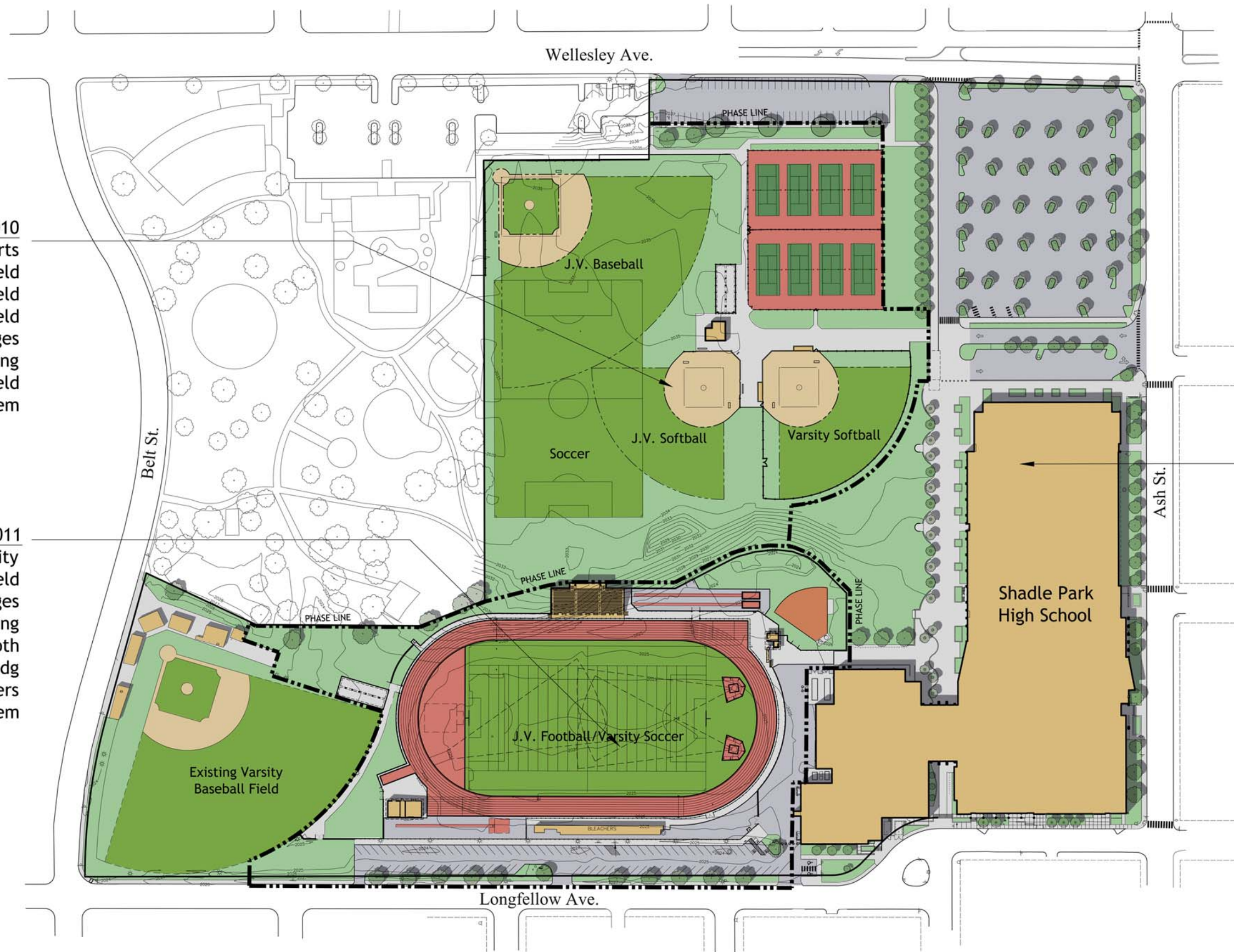

HIGH SCHOOL
 RENOVATION AND
 ADDITIONS

Shadle Park High School Track & Athletic Field and Irrigation Improvements Phases I and II 2010 - 2011

Spokane Public Schools Office of Capital Projects
 200 North Bernard Street Spokane, Washington 99201

SITE PLAN

